

FLYINGMAGNET.COM

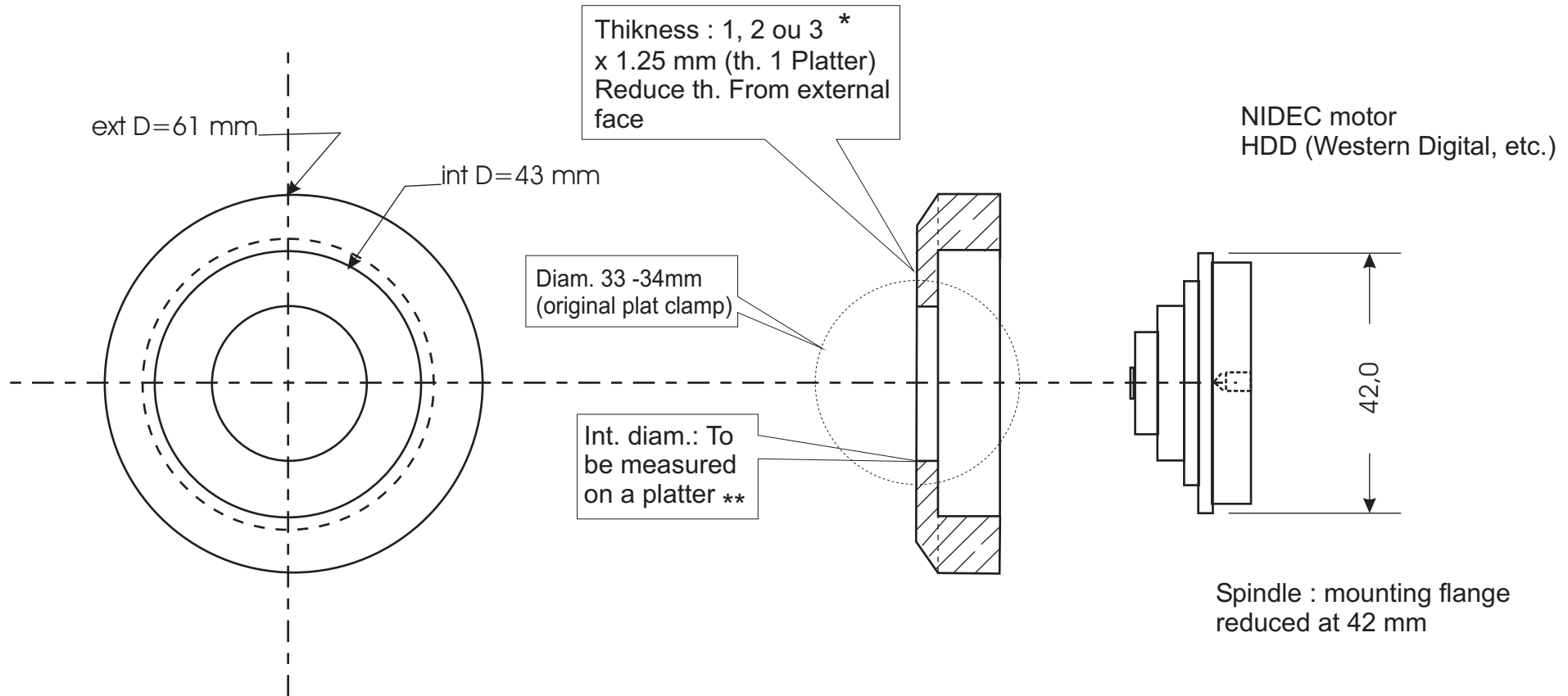

* Reduce (1.25, 2.50 or 3.75 mm) according the possibilities available (risk of deformations of the rotation plan taking into account the thickness of the rings (spacers) and motor available to get the original clamping.

** The actual diameter for a precise centering must be determined from the measured dimensions of the spindle or the platter .

FLYINGMAGNET.COM

Electric gyroscope flywheel
Material : Brass or Inox

FLYINGMAGNET.COM

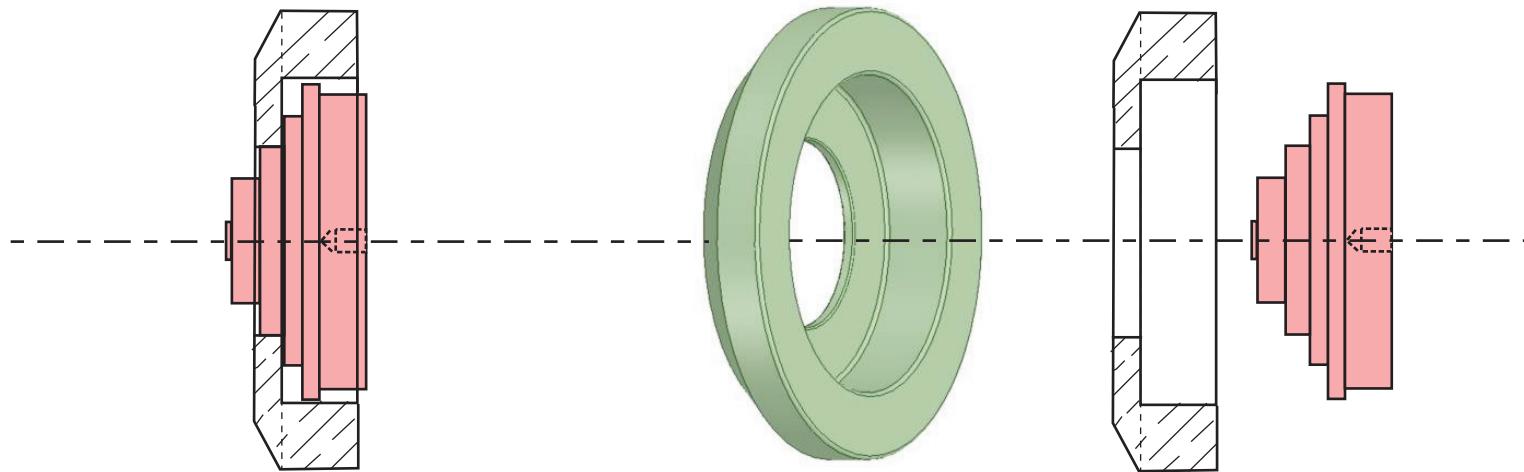

FLYINGMAGNET.COM

Electric gyroscope
Assembly

(mounting flange not modified)

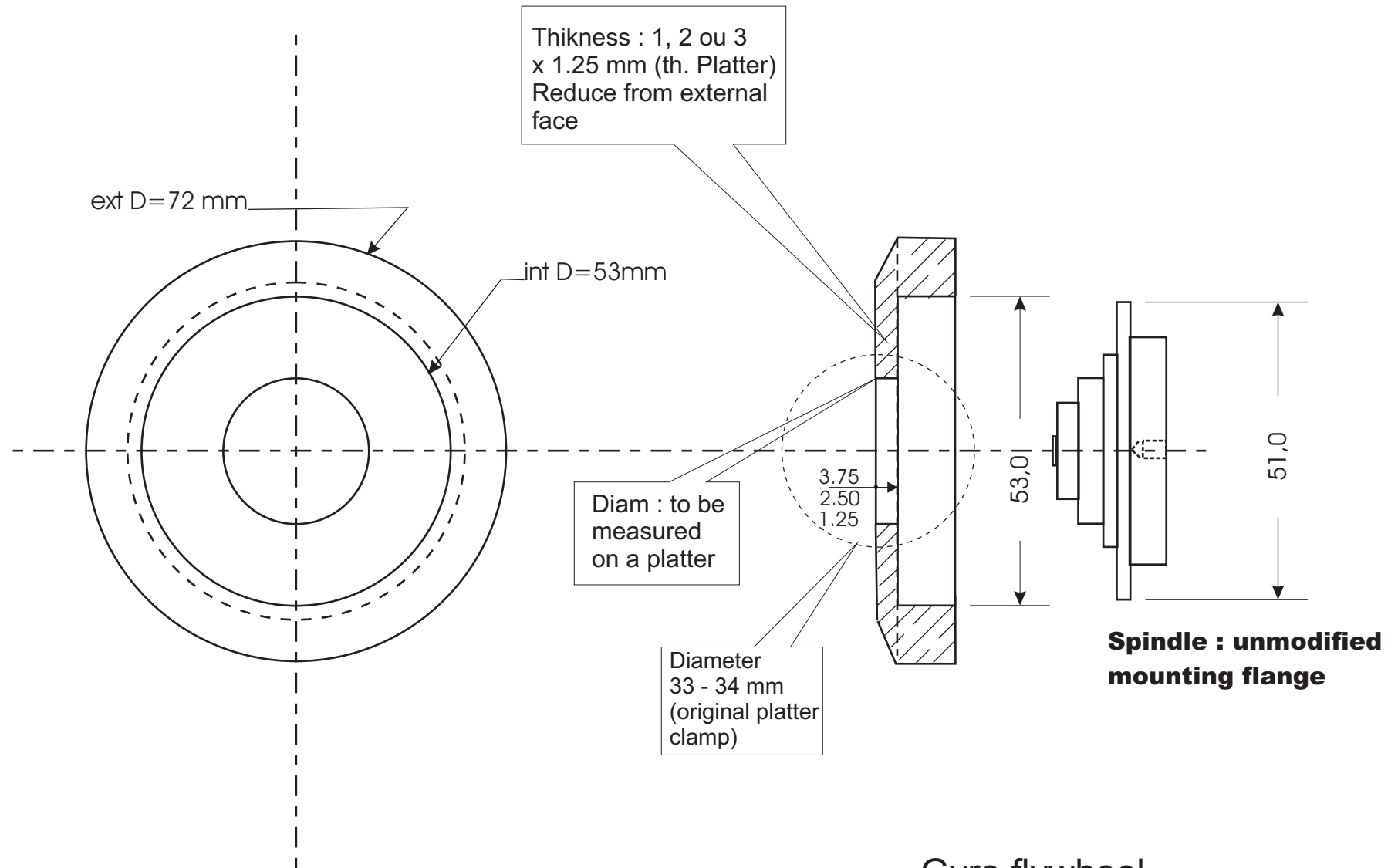

Gyro flywheel
Matériau : Brass / Inox